

## WATERFALL FOUNTAIN

Jardinara Cuadrada Tres

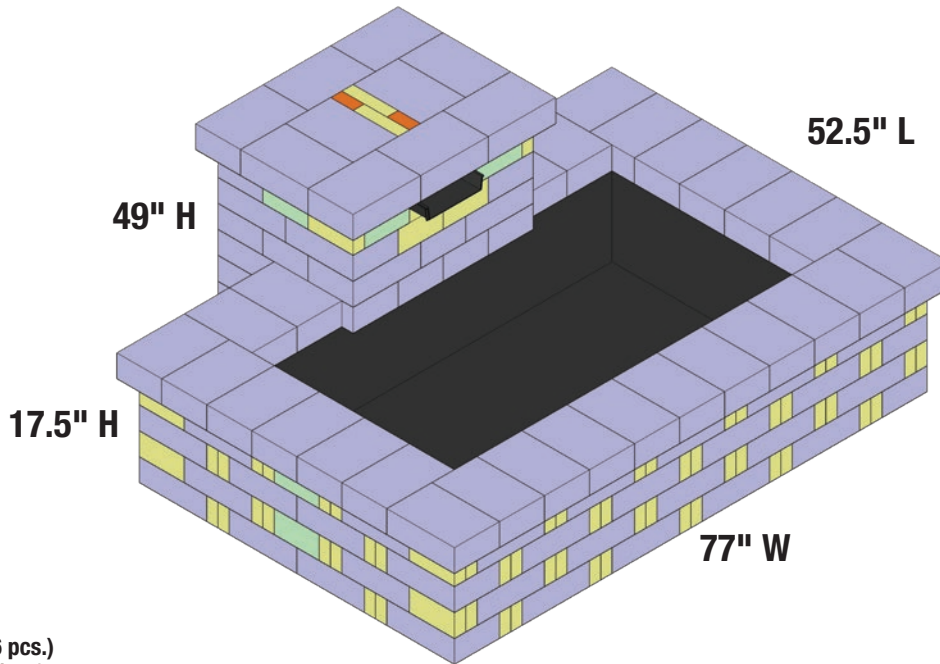

### MATERIALS NEEDED:

Materiales necesitados:

- **1 Pallet of Large (96 pcs.)**  
1 paleta de grandes (96 Piezas)
- **1 Pallet of Mixed/Kitted: 20 Large, 23 Medium and 110 Mini**  
1 paleta de mezcla / Kitted: 20 grande, 23 mediana y 110 mini
- **6 Tubes Quikrete Construction Adhesive**  
Adhesivo de construcción de 6 tubos Quikrete
- **Waterfall Kit**  
Kit de cascada
- **Pond Liner**  
Estanque de estanque
- **2 - 4" x 4" x 8' Cedar Posts**  
2 - 4 "x 4" x 8 'Postes de cedro

### NUMBER OF PIECES PER PROJECT:

Número de piezas por proyecto

	<b>Mini</b> Mini	<b>110</b>		<b>Large</b> Grandes	<b>116</b>
	<b>Medium</b> Medio	<b>23</b>			

Project Instructions: [www.homedepot.com](http://www.homedepot.com)

- **Prepare stable, level project area.** Preparar estable, nivel zona del proyecto.
- **Stack stones, adding construction adhesive between layers.** Pila de piedras, agregando construcción adhesivo entre capas.

\* Measurements for projects are approximate. Las medidas de los proyectos son aproximadas.

**STONE COLORS VARY BY REGION** LOS COLORES DE LOS BLOQUES TIENEN VARIAN DE ACUERDO A LA REGION

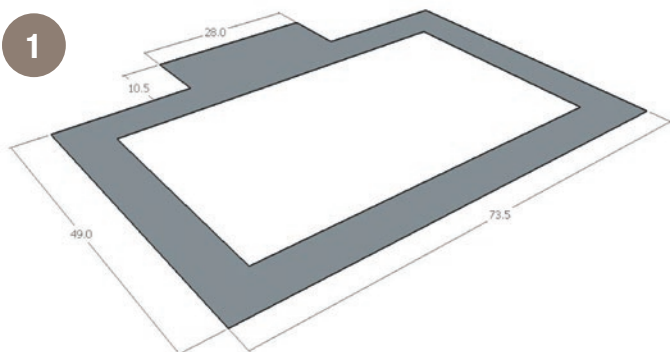

Ensure level build area. Sweep area of debris.

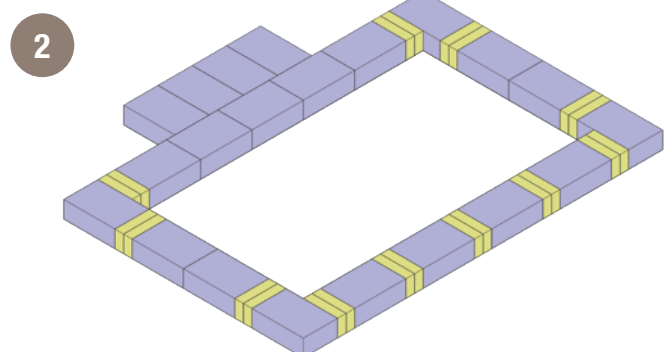

Check square and level. Apply adhesive bead to top of layer.

# RUMBLESTONE® PROJECT BUILDING INSTRUCTIONS

Edificio del proyecto Instrucciones RumbleStone®

**PAVESTONE**  
Creating Beautiful Landscapes®

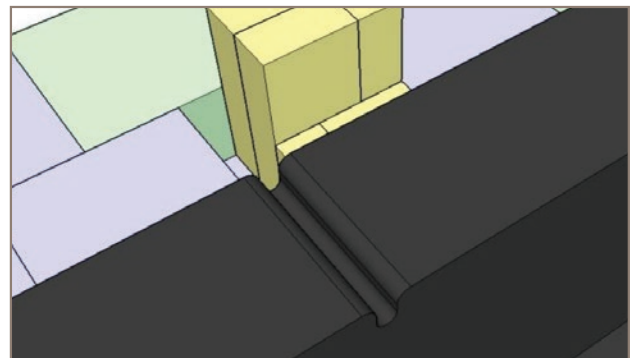
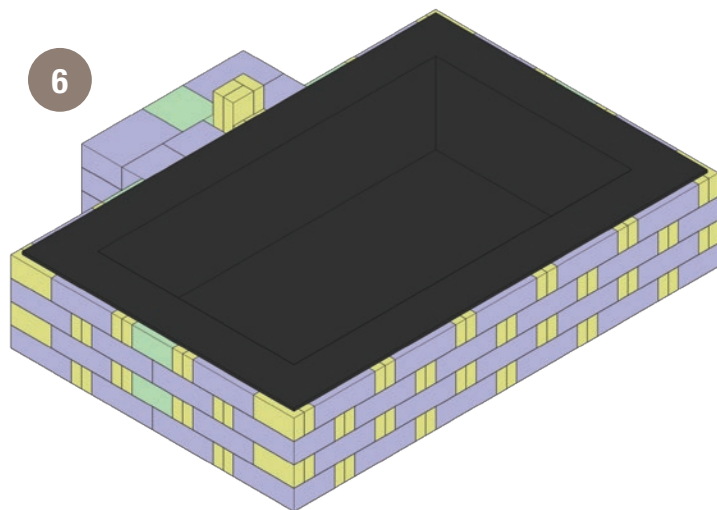
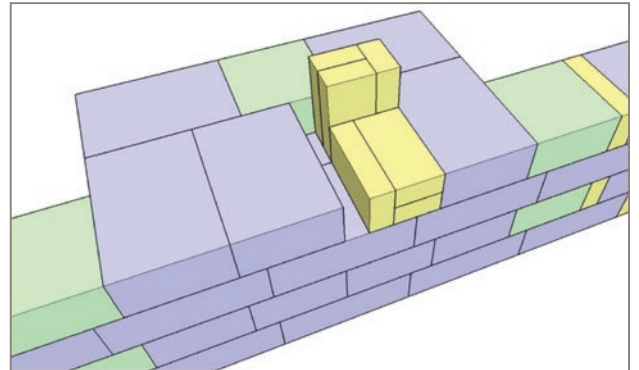
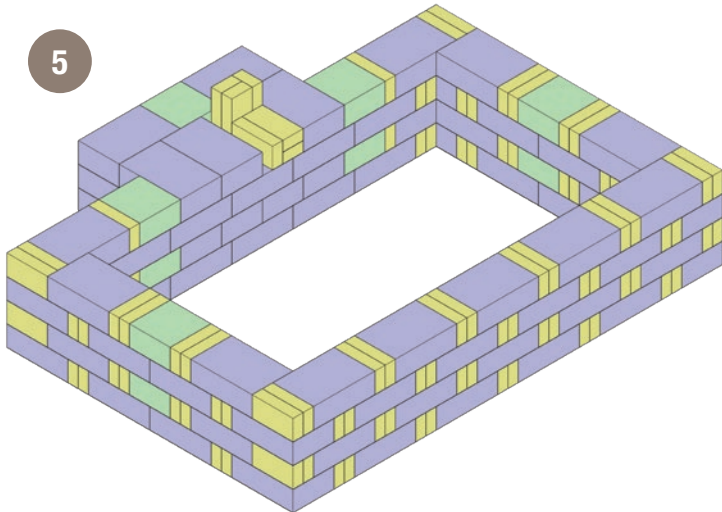
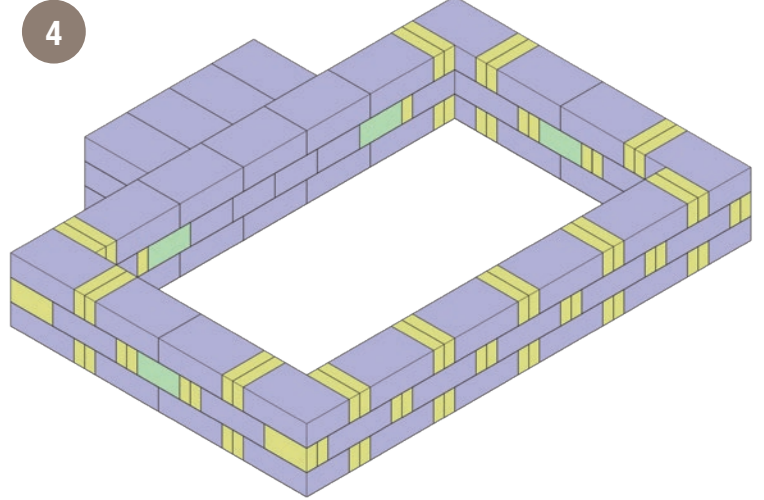
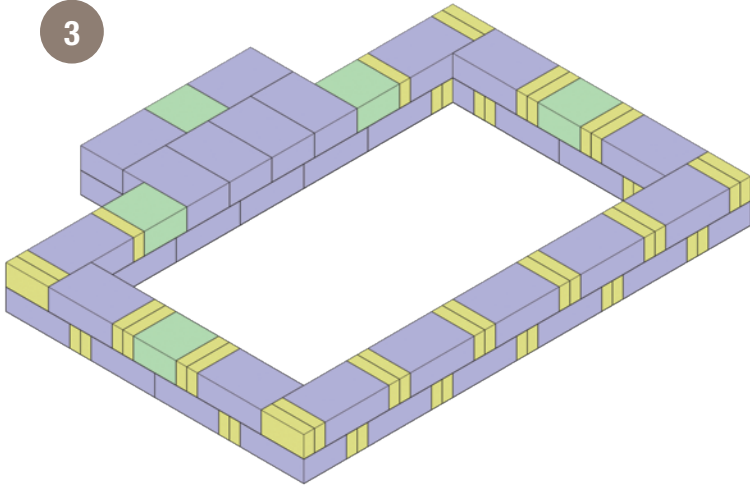

## Liner Installation

Minimize liner thickness by making "hospital corners" and trimming excess materials. Form channel in liner for hose to pass through.

**Imagine. Stack. Create.**

Imagine. Apile. Cree.

[www.homedepot.com/rumblestone](http://www.homedepot.com/rumblestone)

# RUMBLESTONE® PROJECT BUILDING INSTRUCTIONS

Edificio del proyecto Instrucciones RumbleStone®

**PAVESTONE**  
Creating Beautiful Landscapes®

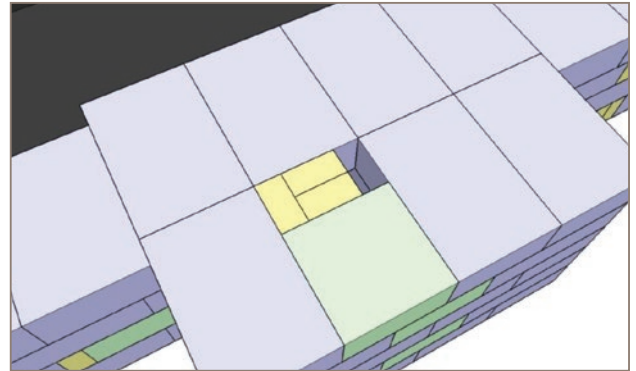
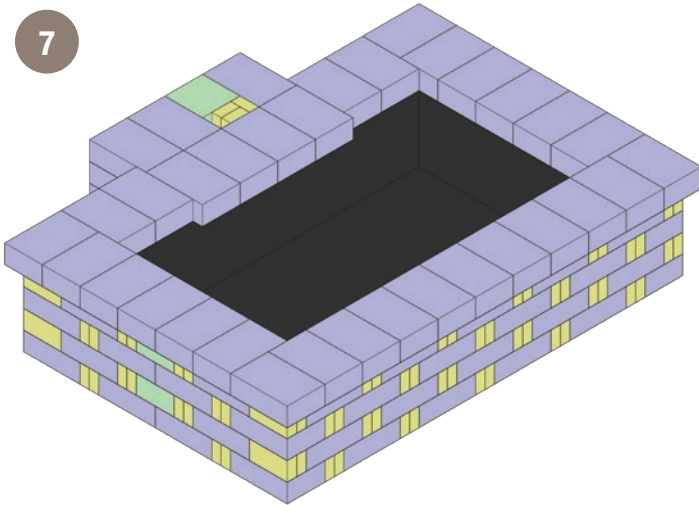

Center coping stones over pool wall stones. Tuck pump power cord between liner and two adjacent coping stones.

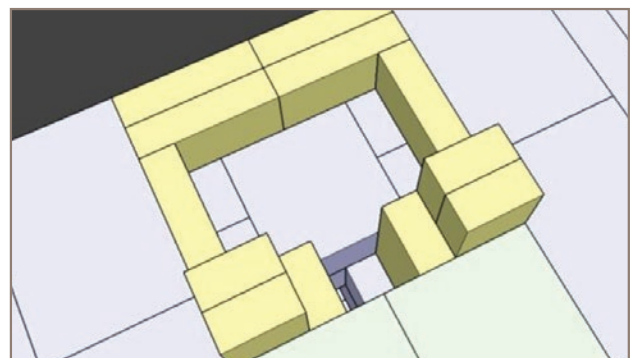
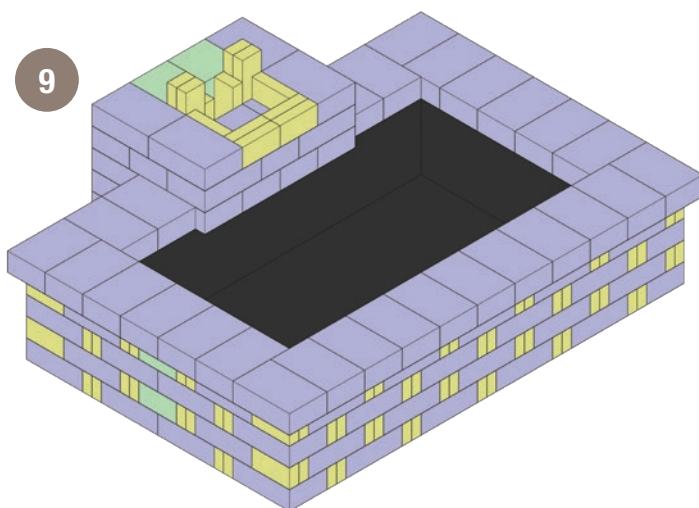
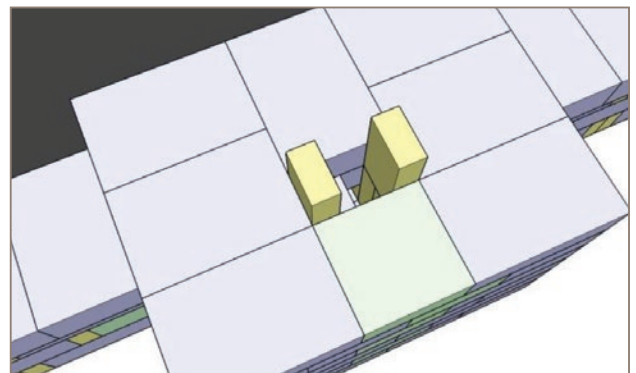
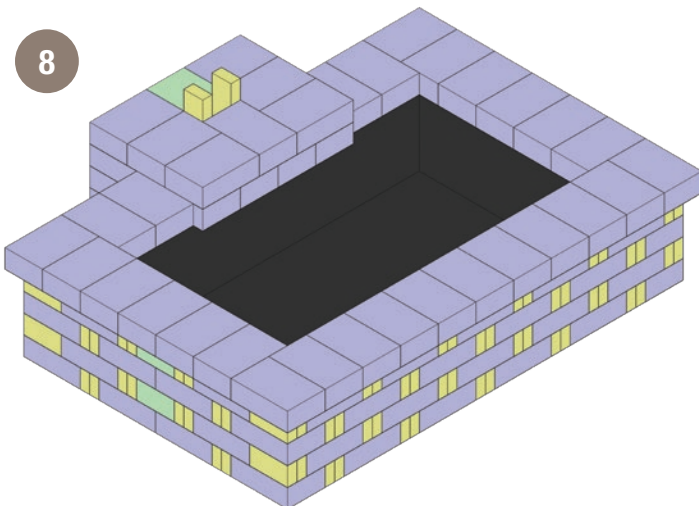

**Imagine. Stack. Create.**

Imagine. Apile. Cree.

[www.homedepot.com/rumblestone](http://www.homedepot.com/rumblestone)

# RUMBLESTONE® PROJECT BUILDING INSTRUCTIONS

Edificio del proyecto Instrucciones RumbleStone®

**PAVESTONE**  
Creating Beautiful Landscapes®

10

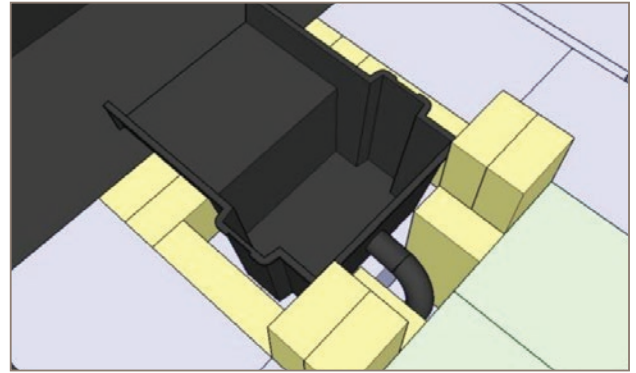
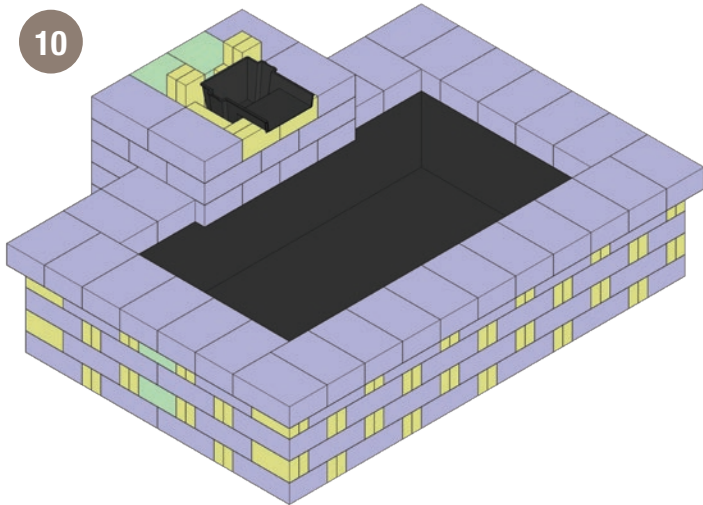

### Basin Installation

Thread hose, leaving plenty of excess to trim on both ends. Place basin. Check square and level. Apply adhesive bead.

11

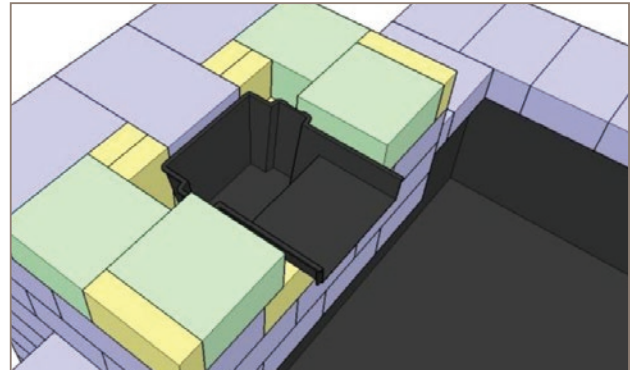
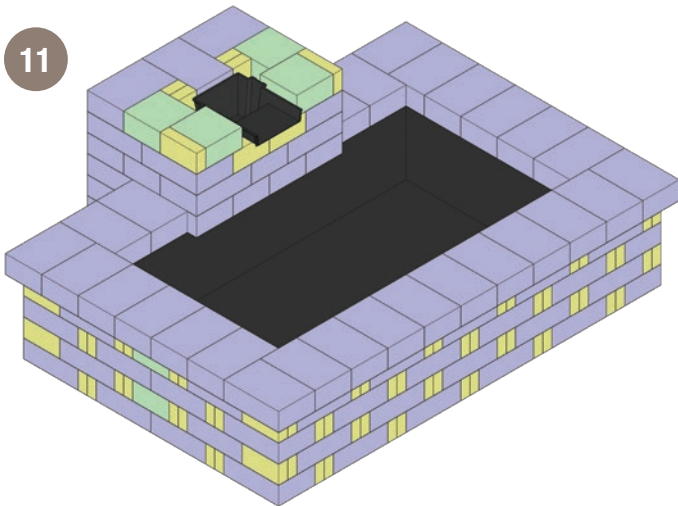

12

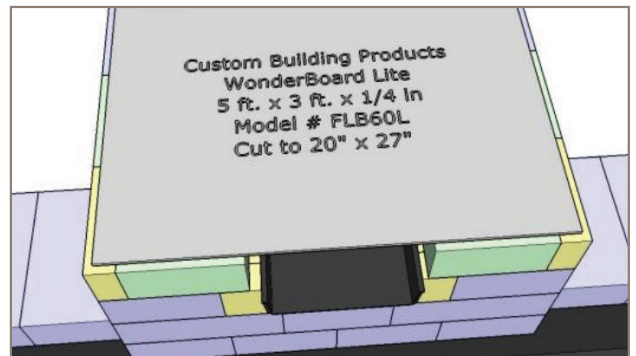
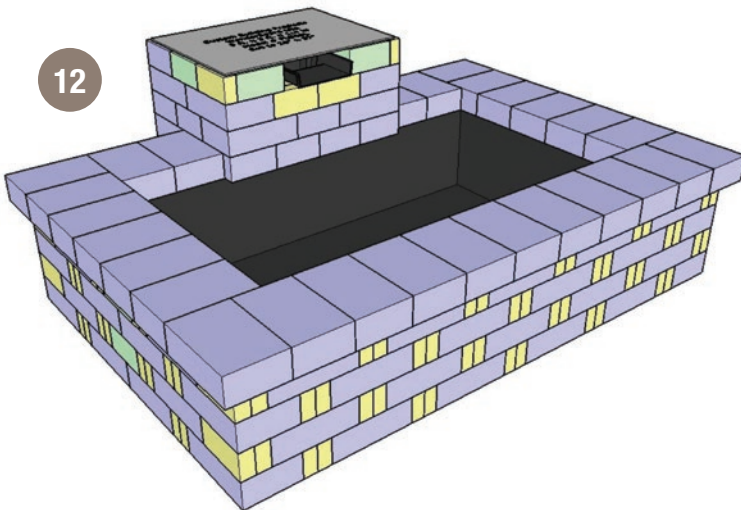

### Wonderboard Installation

Cut Wonderboard to 20" x 27". Apply adhesive bead.

**Imagine. Stack. Create.**

Imagine. Apile. Cree.

[www.homedepot.com/rumblestone](http://www.homedepot.com/rumblestone)

# RUMBLESTONE® PROJECT BUILDING INSTRUCTIONS

Edificio del proyecto Instrucciones RumbleStone®

**PAVESTONE®**  
Creating Beautiful Landscapes®

13

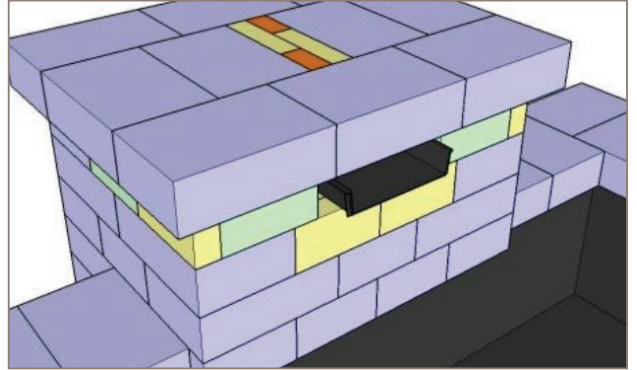
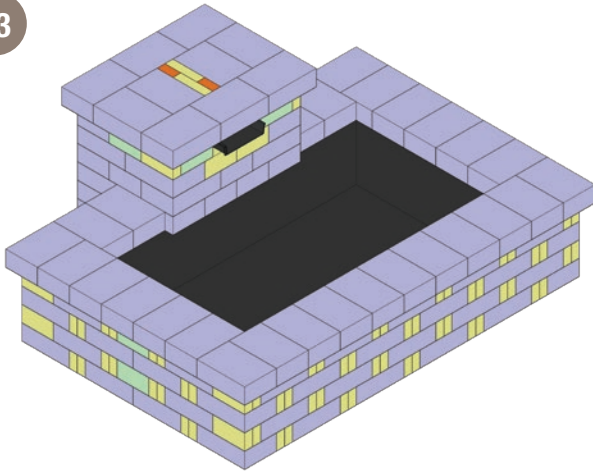

Notes: Orange stones are ends of cut or split Minis.

**Imagine. Stack. Create.**

Imagine. Apile. Cree.

[www.homedepot.com/rumblestone](http://www.homedepot.com/rumblestone)